

MONTERINGSANVISNING GULVBOKSER

Denne monteringsanvisningen er veiledende.

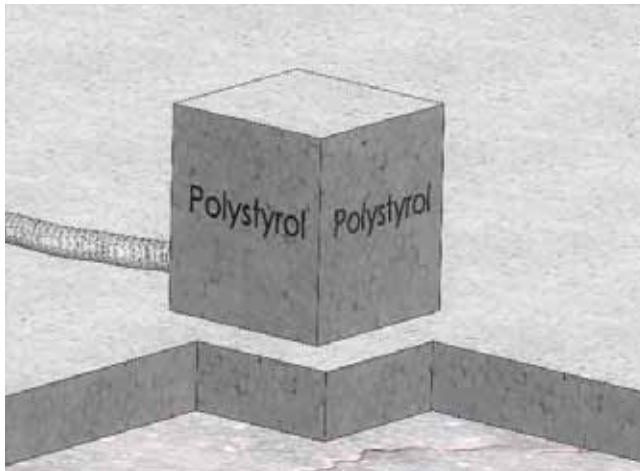

Polystyrol= Isopor blokk

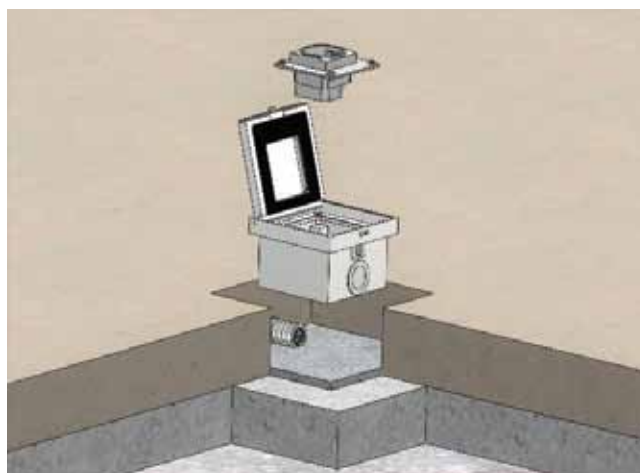
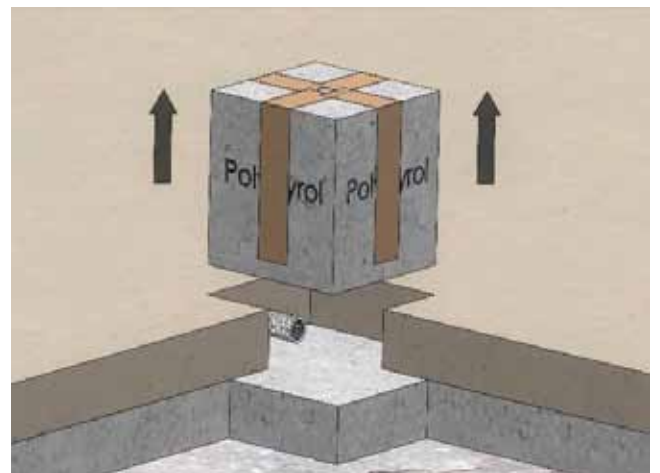
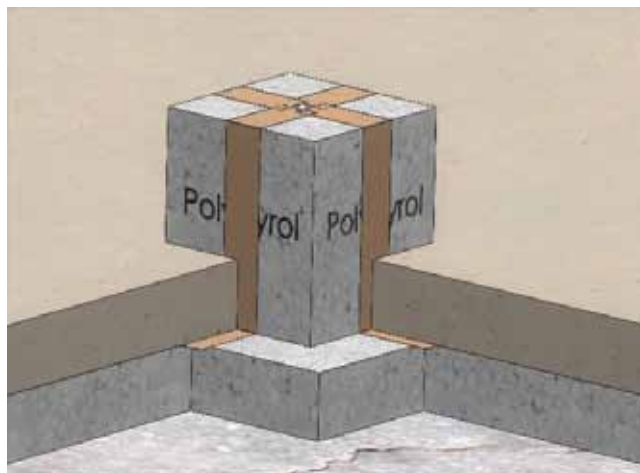
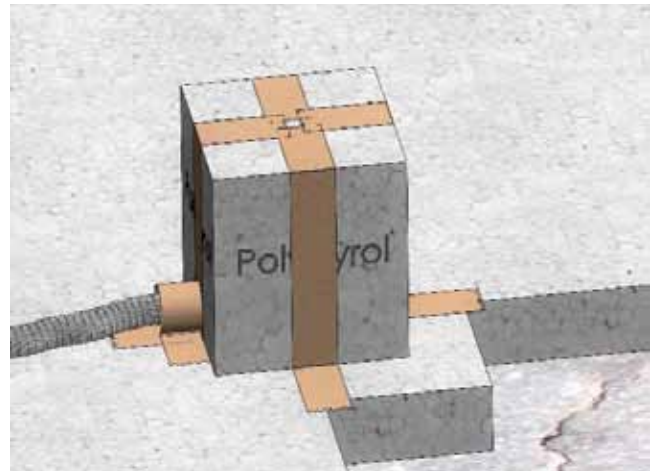

Skru bestykning ut av esken.
Legg gulvboksen i den malte mørtelen.

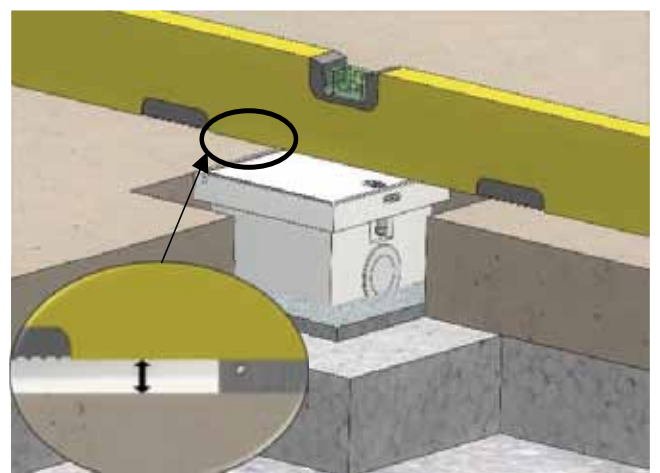

Vurder å dekke til tykkelsen

MONTERINGSANVISNING GULVBOKSER

Denne monteringsanvisningen er veiledende.

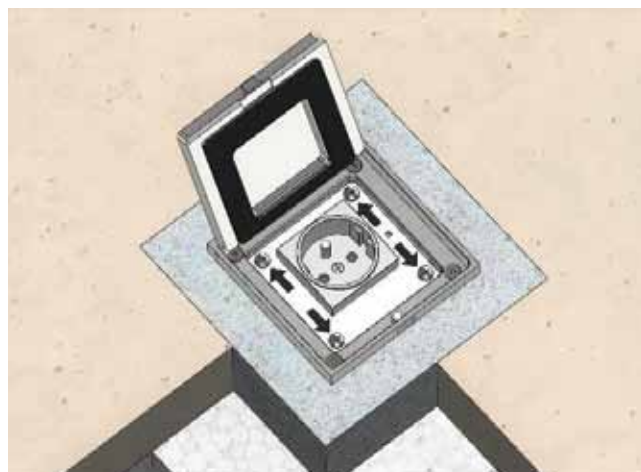
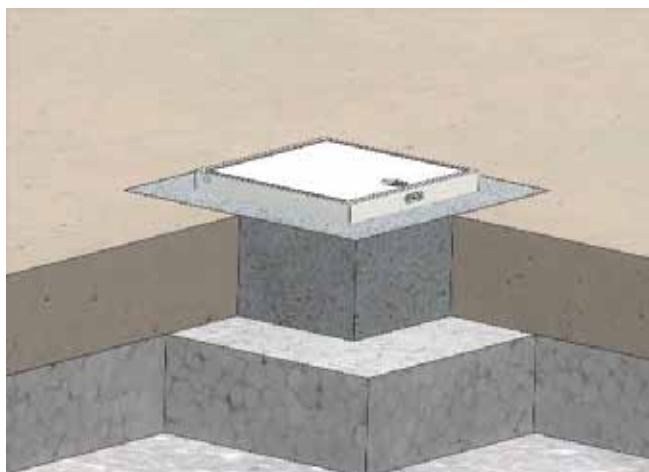

Koble til kabel.
Stram utstyrsbærer.

